



SHAANXI SHINHOM ENTERPRISE CO.,LTD

HBC-XS5 Series Hall Effect Current Sensor

HBC-XS5 Series current sensor with a galvanic isolation between primary and secondary circuit. It provides accurate electronic measurement of DC, AC or pulsed currents.

ELECTRICAL DATA

	HBC10XS5	HBC20XS5	HBC30XS5	HBC50XS5	
Rated input current	10	20	30	50	A
Test current range	32	64	96	150	A
Turns	1600	1600	1600	1333	T
Sampling resistor	100	50	33.3	16.667	Ω
Rated output voltage	0.625±0.5%				V
Supply voltage	+5±5%				V
Reference voltage (VR)	2.5±0.5%				V
Offset voltage Drift -40~+85°C	≤±0.5				mV°C
Linearity	≤±0.2				%FS
Class	≤±0.7				%
di/dt	> 50				A/μS
Response time	< 1				μS
Bandwidth	DC~200				KHZ
Insulation voltage	1.5				KV
Operating Temperature	-40~+85				°C
Storage Temperature	-40~+105				°C

MUTING DIMENSIONS(FOR REFERENCE ONLY)

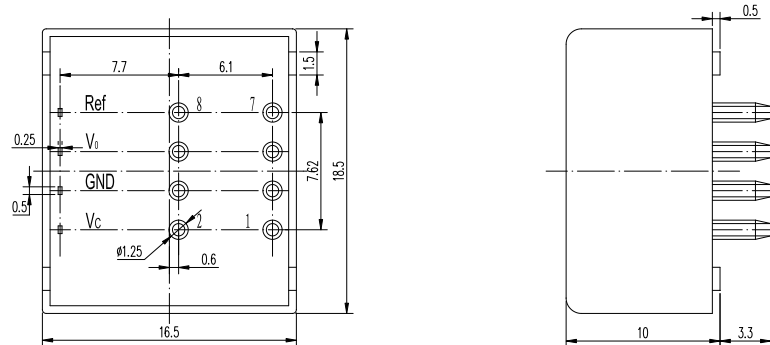

THE WIRING DIAGRAM

Turns	Turns ratio	Rated input current IPN[A]	Rated output voltage VOUT[V]	Pri DCR[mΩ]	Pri inductance [μH]	Terminal
Single phase	1	±10(±20, ±30,±50)	2.5±0.625	0.05	0.025	
	2	±5(±10, ±15,±25)	2.5±0.625	0.20	0.1	
	4	±2.5(±5, ±7.5, ±12.5)	2.5±0.625	1.00	0.4	
three-phase	1	±10(±20, ±30)	2.5±0.625	0.05	0.025	